

# CK-1 Series

## LED HIGH BAY LIGHT



<b>Project:</b>	
<b>Type:</b>	
<b>Catalog#:</b>	

LED High bay light CK-1 adopts qualified super bright LED as light source which is stable, long life and no UV & IR emission. The specially designed aluminum housing is stylish and fashionable with excellent heat management. Integrated with the latest inventronics ESD driver and powered by low-voltage constant current driver which offers excellent energy savings and longevity. The whole structure well ensures IP65 waterproof and a 5 year warranty.

### Specifications and Features:

- Delicate appearance with unique design
- Up to 130 lm/watt can replace traditional HID luminaire from 250W to 1000W
- Faster heat dissipation with larger heat radiating area the solder joint temperature can be controlled very well
- Superbly reliable inventronics ESD driver with built in 1-10V / PWM dimming function

Power	Mode	Lumen Output	Efficacy
100W	CK-1-HB100W12110	13000 lm	130lm/w
150W	CK-1-HB150W12110	19500 lm	130lm/w
200W	CK-1-HB200W12110	26000 lm	130lm/w
240W	CK-1-HB240W12110	31200 lm	130lm/w



### Dimension

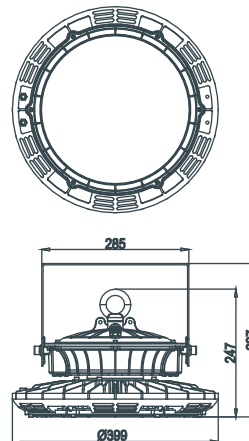

### Smart control

#### 1-10V,PWM signal and Resistance

Combined with 1-10V or PWM dimmer you can save energy up to 50%



#### Dali or push dim converter

Meanwell DALI optional, giving you the best control solution and energy saving upgrade.



#### Dimmable+Microwave motion sensor

Combined with motion sensor, you can save energy up to 80%

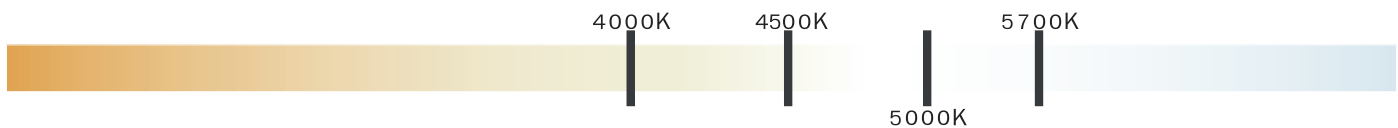

Color Rendering Index	>80	Input Voltage	AC 277-480 V
Rated Life	50,000 Hrs	Power Factor	>0.95
Housing	Aluminum	IP	IP 65
Beam Angle	60°/90°/110°	Net Weight	8.0 KG
Operating Temperature	-30 °C to +60 °C	Outer carton	48*48*23 cm

# Installation Manual

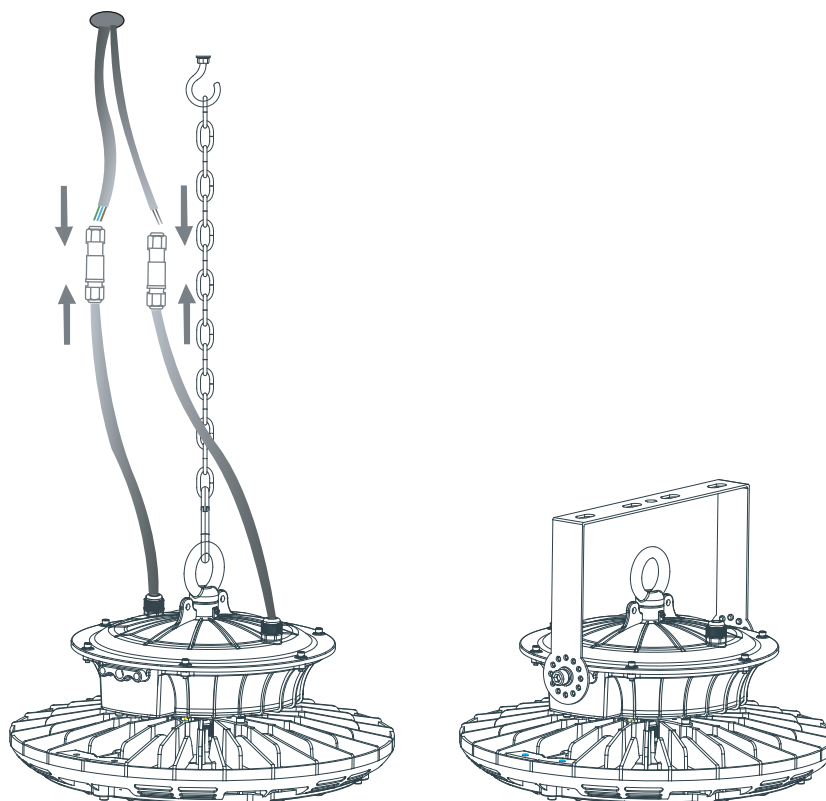

Intertek  
5004830

- SUITABLE FOR DAMP LOCATIONS  
CONVIENT AUX EMPLACEMENTS HUMIDES  
SUITABLE FOR OPERATION IN AMBIENT NOT EXCEEDING 45  
PEUT ÊTRE UTILISÉ À UNE TEMPÉRATURE AMBIANTE N'EXCÉDANT PAS 45°C
- MIN 75°C SUPPLY CONDUCTORS  
LES FILS D'ALIMENTATION 75°C MIN
- CONSULT A QUALIFIED ELECTRICIAN TO ENSURE CORRECT BRANCH CIRCUIT WIRING  
BRANCH CIRCUIT CONDUCTOR  
CONSULTER UN ÉLECTRICIEN QUALIFIÉ POUR VOUS ASSURER QUE LES CONDUCTEURS DE LA  
DÉRIVATION SONT ADÉQUATS
- CAUTION – RISK OF FIRE  
ATTENTION – RISQUE D'INCENDIE  
CAUTION – RISK OF SHOCK  
ATTENTION – RISQUE DE CHOC



Keep at an ambient temperature of -30°C to +50°C



Please make sure the power off before operation

## LED HIGH BAY LIGHT ( Non-Dimmable )

### Chain Installation Manual

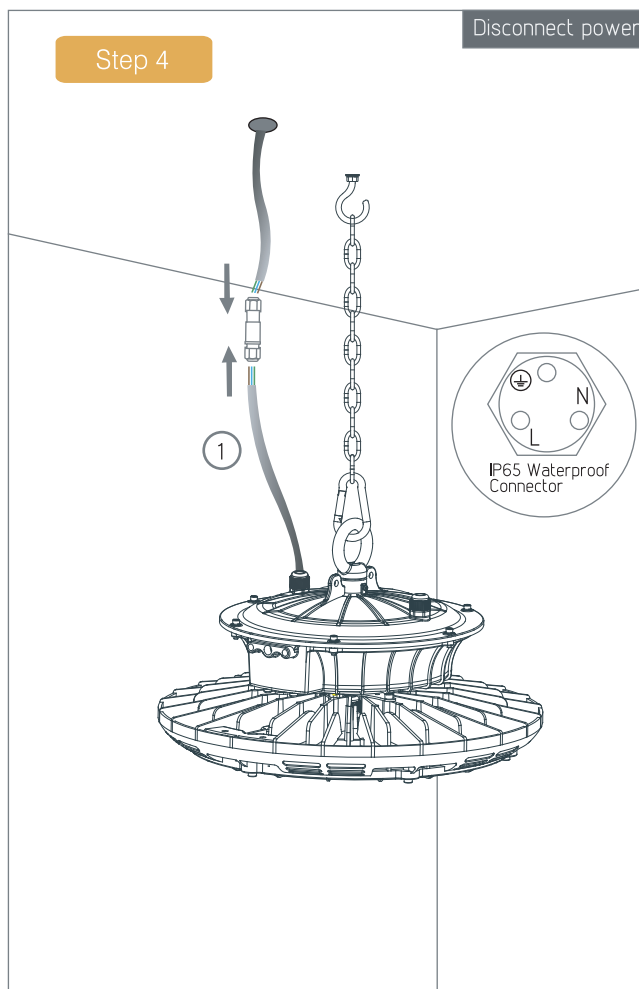
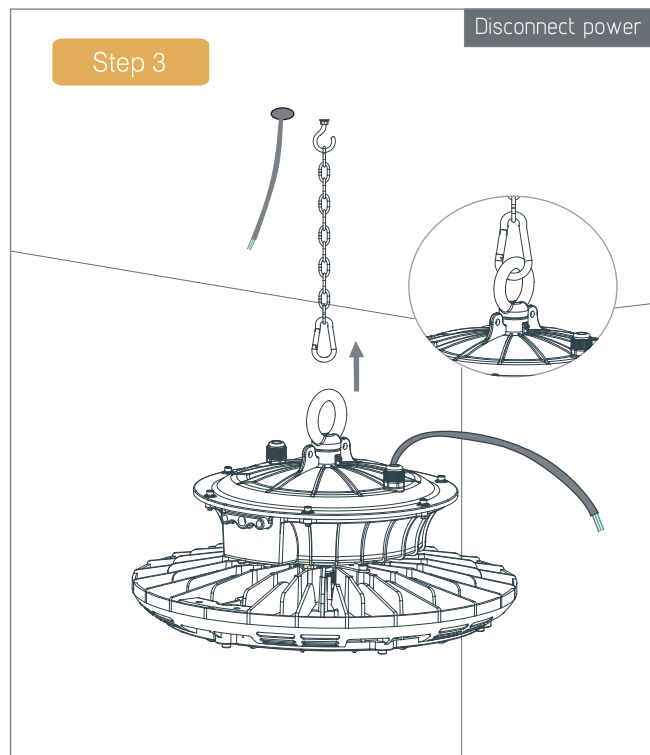
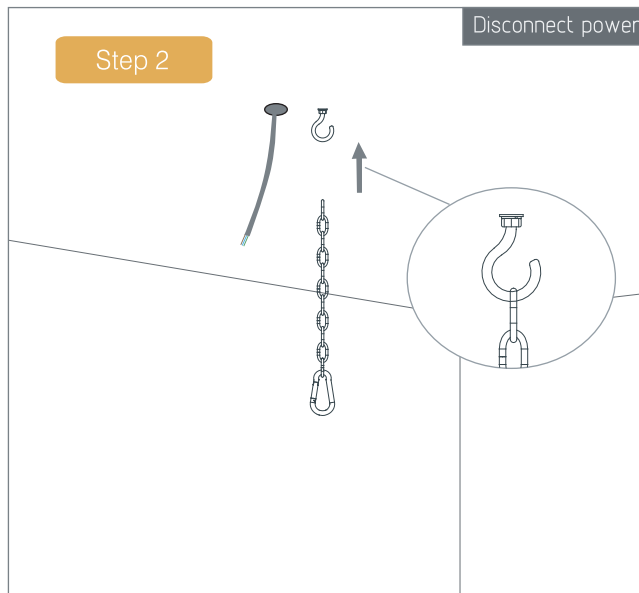
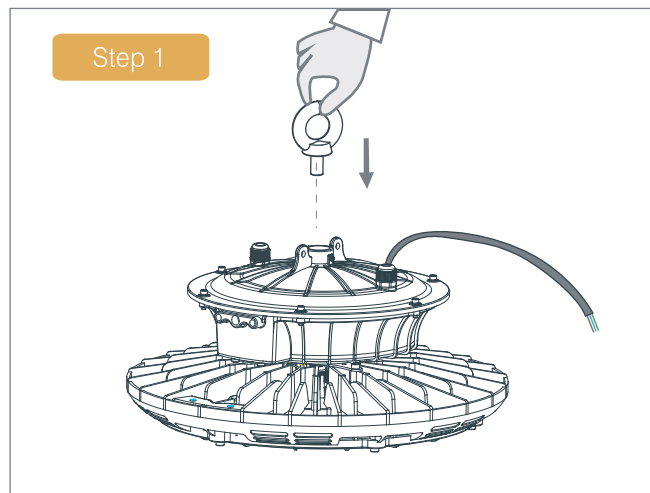

#### Note:

① AC 277-480 V  
Cable

**INVENTRONICS**

L Brown  
N Blue  
⊕ Green/Yellow

#### Warning:

- Please make sure the power off before operation

## LED HIGH BAY LIGHT ( Dimmable )

### Chain Installation Manual

Step 1

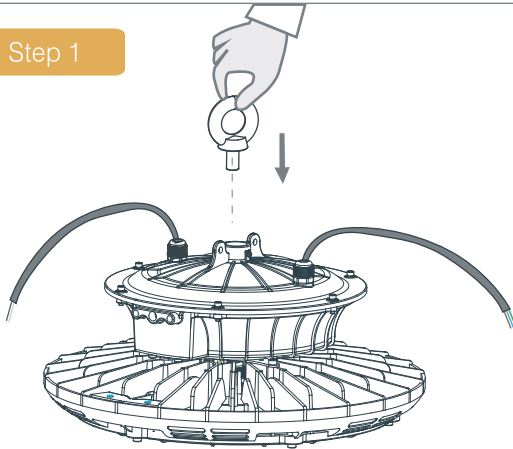

Step 2

Disconnect power

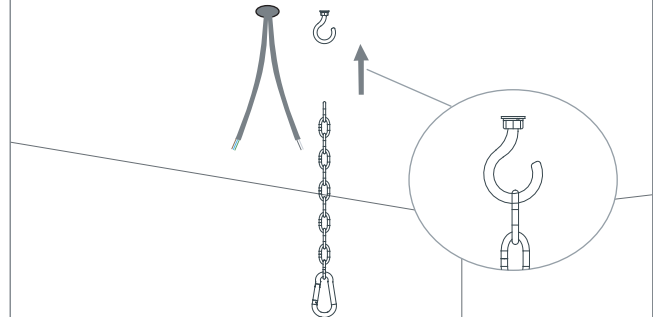

Step 3

Disconnect power



Step 4

Disconnect power

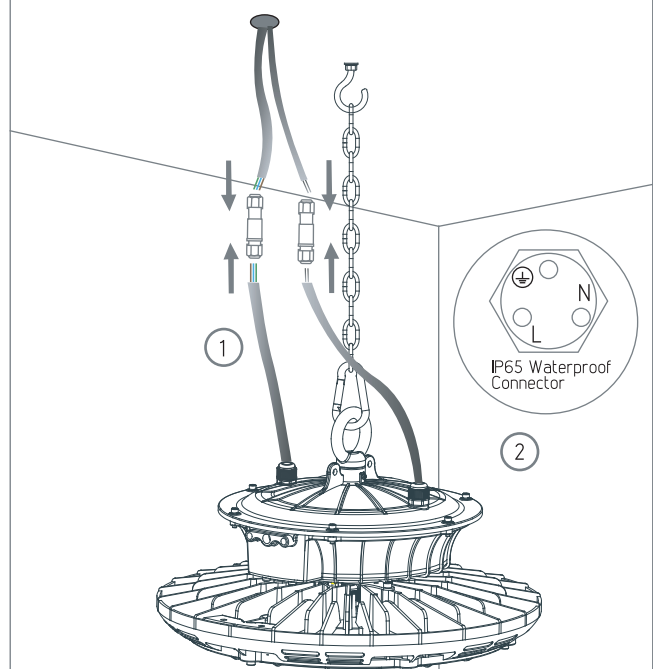

#### Note:

**INVENTRONICS**

①

AC 277-480 V  
Cable

L Brown  
N Blue  
Green/Yellow

②

PWM/1-10V Dimming!  
Cable

DIM+ Purple  
DIM- Gray  
Vaux/12V Black/White

#### Warning:

- Please make sure the power off before operation
- If don't need dimming, please protect the 1-10V output with the protection caps provided with the product